



6 Brookview Court, Dronfield, S18 2HT

Saxton Mee



# 6 Brookview Court

Price Guide

## £180,000

Price guide £180,000 - £190,000

A rare opportunity to purchase a TWO BEDROOMED bungalow within this small mews development of similar retirement properties for the over 55's situated on the grounds of the nursing home which offers assistance and meals if required (subject to fees).

The property is ready for immediate occupation with no upward chain and vacant possession and has been well maintained. The bungalow is offered for sale with the added benefit of being FREEHOLD which reduces the annual maintenance charge for the gardens and grounds.

Occupying an excellent position with the garden at the rear enjoying predominantly a favoured southerly aspect. Having gas fired central heating and double glazing the accommodation briefly comprises of a hallway with cloaks/store cupboard, dining/breakfast kitchen, living room with French door to the garden, two bedrooms and a shower room.

Communal gardens and grounds. Sitting out area to the rear with patio. Off road parking.

Maintenance charges £64.16 per month



- Sought after over 55's mews development
- Lovely "community" feel
- Two bedrooms
- Care/meal assistance if required (subject to fees)
- Freehold
- Communal parking area
- Favoured southerly rear aspect
- Gas central heating and double glazing
- No upward chain
- Council Tax Band: C / EPC: D







## 6 BROOKVIEW COURT

APPROXIMATE GROSS INTERNAL AREA  
63.2 SQ M / 680 SQ FT

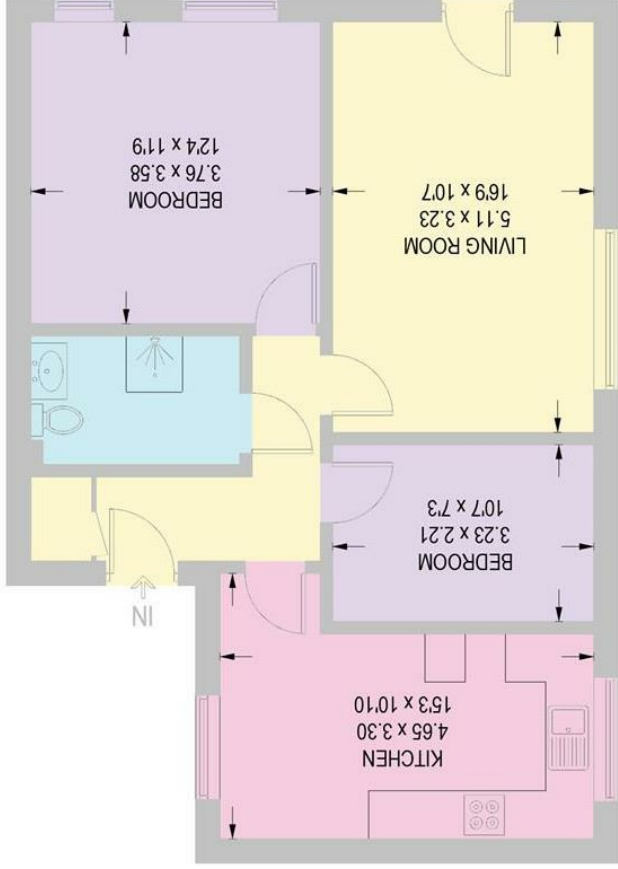

## GROUND FLOOR

Illustration for identification purposes only.  
measurements are approximate, not to scale.



Banner Cross  
T: 0114 268 3241  
E: bannercross@saxtonmee.co.uk  
www.saxtonmee.co.uk

Dronfield  
T: 01246 290992  
E: dronfield@saxtonmee.co.uk

Hathersage  
T: 01433 650009  
E: hathersage@saxtonmee.co.uk

Bakewell  
T: 01629 815307  
E: bakewell@saxtonmee.co.uk

Matlock  
T: 01629 828250  
E: matlock@saxtonmee.co.uk

While we endeavour to make our sales particulars fair, accurate and reliable, they are only a general guide to the property and, accordingly, if there is any point, which is of particular importance to you, please contact the relevant office. The Agents have not tested any apparatus, equipment, fittings or services and so cannot verify they are in working order. The buyer is advised to obtain verification. Please note all the measurement details are approximate and should not be relied upon as exact. All plans, floor plans and maps are for guidance purposes only and are not to scale. Under no circumstances should they be relied upon as exact or for use in planning carpets and other such fixtures, fittings or furnishings. YOUR HOME IS AT RISK IF YOU DO NOT KEEP UP REPAYMENTS ON A MORTGAGE OR OTHER LOAN SECURED ON IT. A Life Assurance policy may be requested. Written Quotations of credit terms available on request.